

A photograph of a bright, modern interior space, likely a hallway or living area. On the left, there is a white door with a silver handle. The walls are white, and the floor is made of light-colored wood. A white radiator is mounted on the wall in the background. On the right wall, there is a large, octagonal clock with a white face and black numbers. The clock is mounted on the wall. The text "Nottingham Road" is written in a large, white, serif font, and "Loughborough" is written in a smaller, white, sans-serif font below it.

Nottingham Road

Loughborough

2 Bed Ground Floor Apartment • LE11ES • £740 pcm • £850 Deposit



Nottingham Road, Loughborough

Conveniently situated on this popular road, between the town centre and train station. This ground-floor apartment is a great choice for those wanting to be near all the towns amenities. Accommodation comprises a kitchen; living room; two large double bedrooms; a shower room and separate water closet; uPVC double glazing and central heating.

Lounge 6.03m (19'9) x 3.26m (10'8)

A large living space located at the front of the apartment. Access out of the front of the property as well as multiple windows for added light.

Kitchen 2.7m (8'10) x 2.02m (6'8)

A well-arranged kitchen with a significant amount of cupboard space as well as an electric cooker and a washing machine.

Master Bedroom 4m (13'1) x 3.87m (12'8)

Located at the rear of the property, a large double bedroom.

Bedroom Two 6.03m (19'9) x 2.98m (9'9)

With two rooms opened into one, a second large double bedroom.

Shower Room 1.34m (4'5) x .75m (2'6)

A quaint space including only a shower. A separate water closet is located at the rear of the property.

Garden

A shared courtyard at the rear of the property.

Parking

Restricted parking available on neighbouring streets.

Heating

Gas-fired central heating.

Glazing

Modern, good quality, uPVC double glazing.

Energy Performance

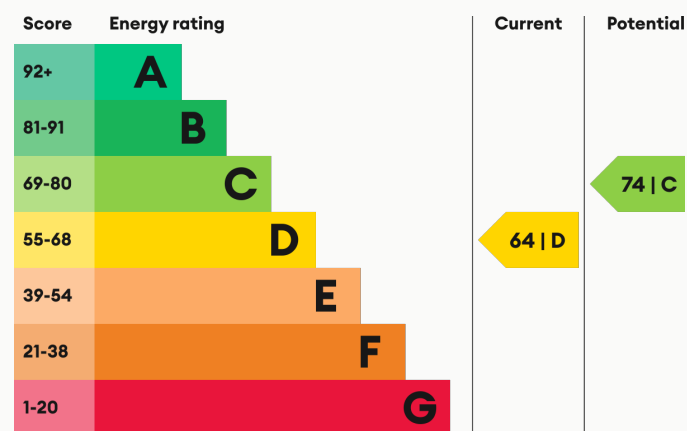

We aim to make our particulars both accurate and reliable. However they are not guaranteed; nor do they form part of an offer or contract. If you require clarification on any points then please contact us, especially if you are traveling some distance to view. All measurements are to widest point.



Lounge



Lounge



Kitchen



Kitchen

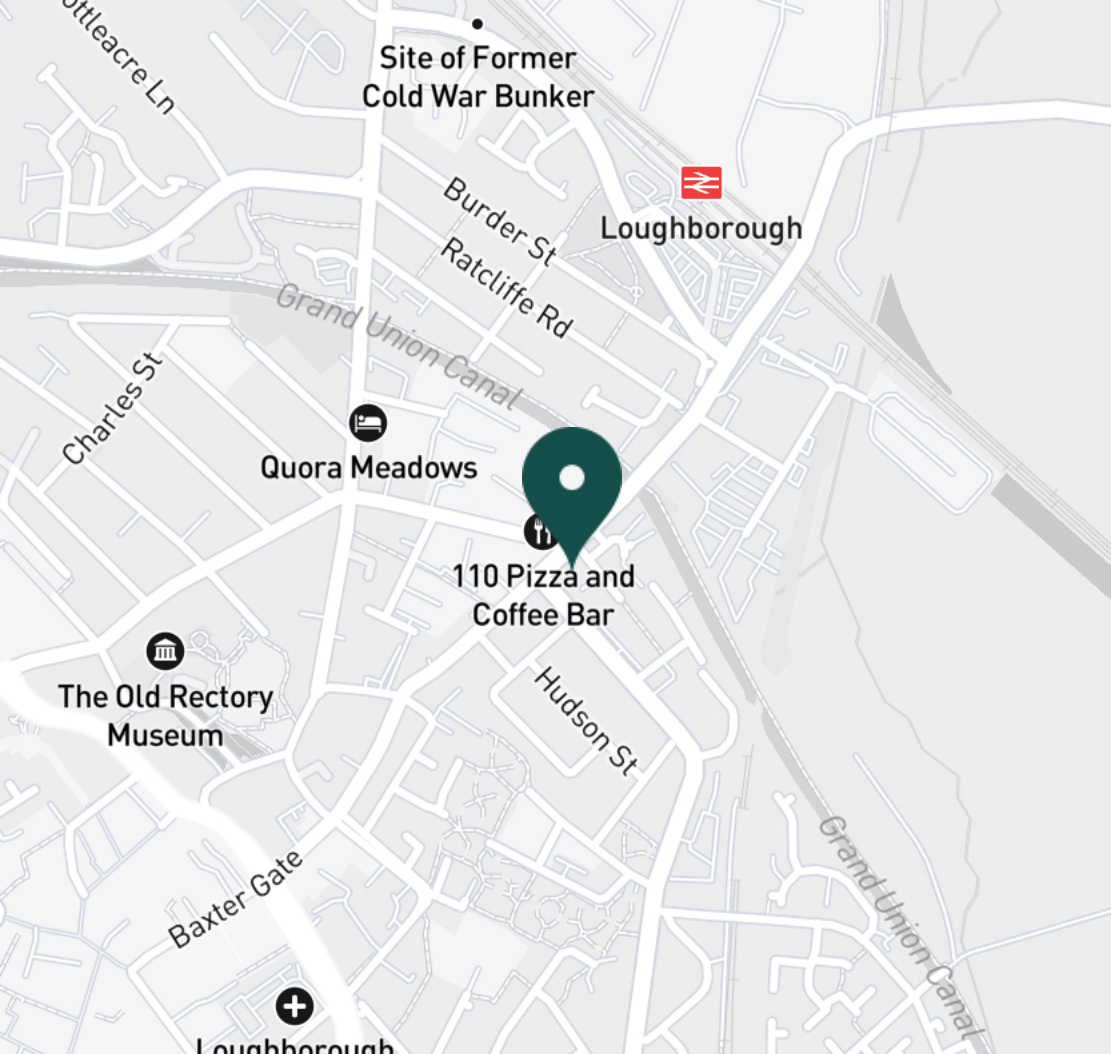

SUPERMARKETS

Tesco Superstore Loughborough	0.6 mi
Marks & Spencer	0.7 mi
Aldi Loughborough	0.8 mi
Lidl Loughborough	0.9 mi
Sainsburys Loughborough	1.0 mi

GYMS

CrossFit Loughborough	0.3 mi
PureGym Loughborough	0.5 mi
Anytime Fitness Loughborough	0.6 mi
Dynamite Gym Ltd	0.6 mi
NPC Performance Centre	0.8 mi

TRAIN STATIONS

Loughborough	0.4 mi
Barrow upon Soar	4.0 mi
Sileby	5.8 mi
Syston	10.1 mi
East Midlands Parkway	10.3 mi

NURSERY SCHOOLS

Cobden Childrens Centre	0.4 mi
Babblebrooke Day Nursery	0.5 mi
Lime Tree Nursery	0.6 mi
Small World Nursery	0.9 mi
Busy Bees in Loughborough	1.0 mi

PRIMARY SCHOOLS

Rendell Primary School	0.3 mi
Cobden PS	0.6 mi
Fairfield Preparatory Sch	0.8 mi
St Marys Catholic PS	0.9 mi
Loughborough Grammar Sch	1.1 mi

HIGH SCHOOLS

Limehurst Academy	0.4 mi
Loughborough Grammar Sch	1.1 mi
Our Lady's Convent Sch	1.1 mi
Loughborough High Sch	1.1 mi
RNIB College Loughborough	1.2 mi

Discover
Loughborough

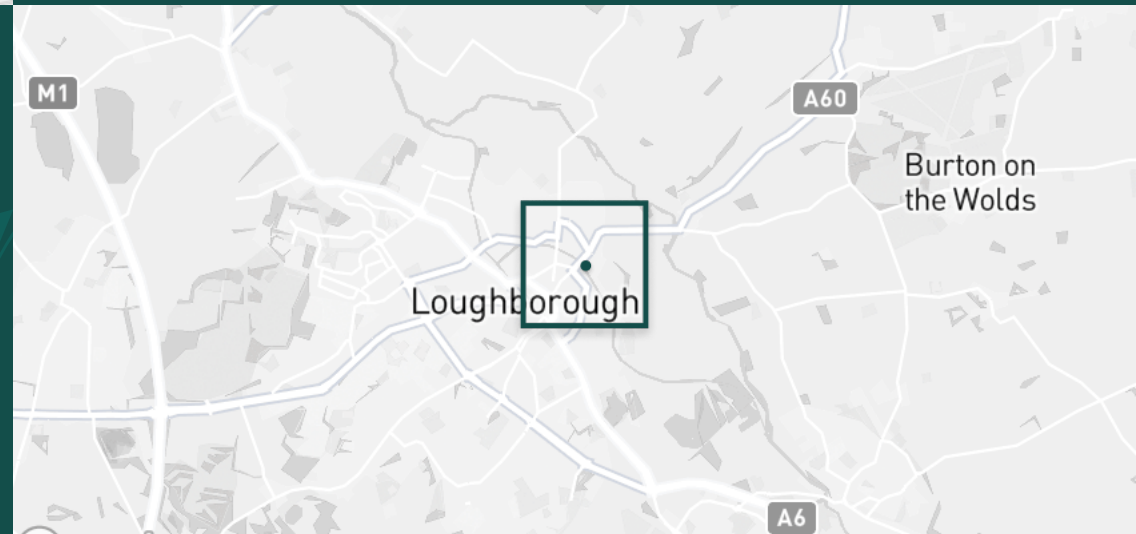

- ✓ Ground Floor Apartment
- ✓ Two Bedrooms
- ✓ Town Centre
- ✓ Close to Train Station
- ✓ Available Now
- ✓ Loughborough





Master Bedroom



Master Bedroom



Master Bedroom



Bedroom Two



Bedroom Two



Bedroom Two



Bedroom Two



Shower Room



Water Closet



Nottingham Road



Courtyard

Available
From 27/03/2025

Comes
Unfurnished

Bedrooms
2

Receptions
1

Bathrooms
1

Parking
With permit

Postcode
LE111ES

Rent
£740 pcm

Deposit
£850

EPC
64 | D

Council Tax Band
A

ID
#9175

Updated
27/03/2025

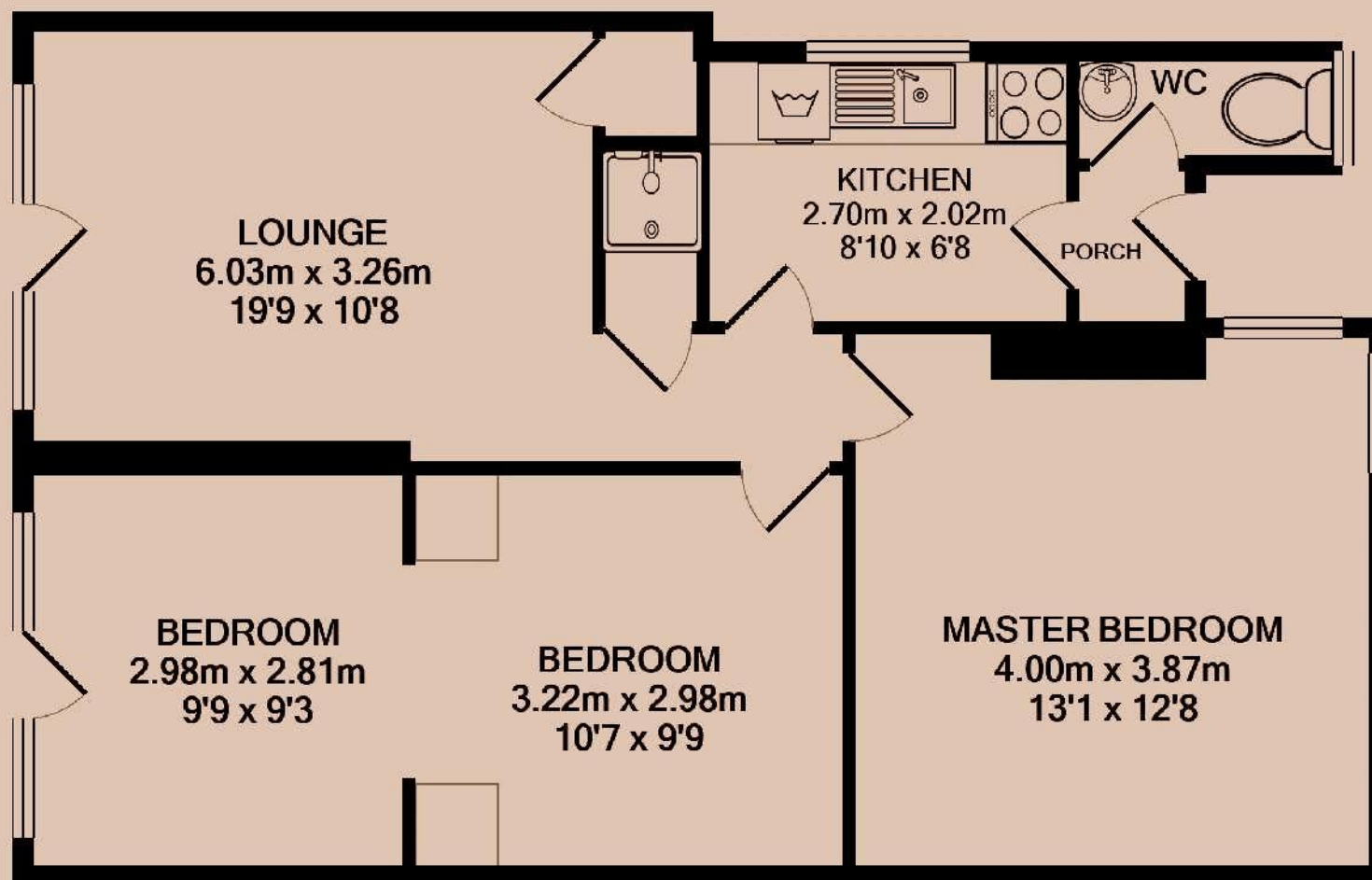

Have a property like this? Let's work together.

Design and marketing are at the heart of our approach. With most people now looking for property online, we can get our clients' properties in front of as many people as the most prominent national agents. Where we differ is in the quality of our work. We create stunning digital particulars that highlight the individual attributes of every property we market, with videos and floor plans as standard.



OUR OFFICE
7 Biggin Street
Loughborough, LE11 1UA

CONTACT US
01509 320 320
let@huntleys.net

